

042617_A.U

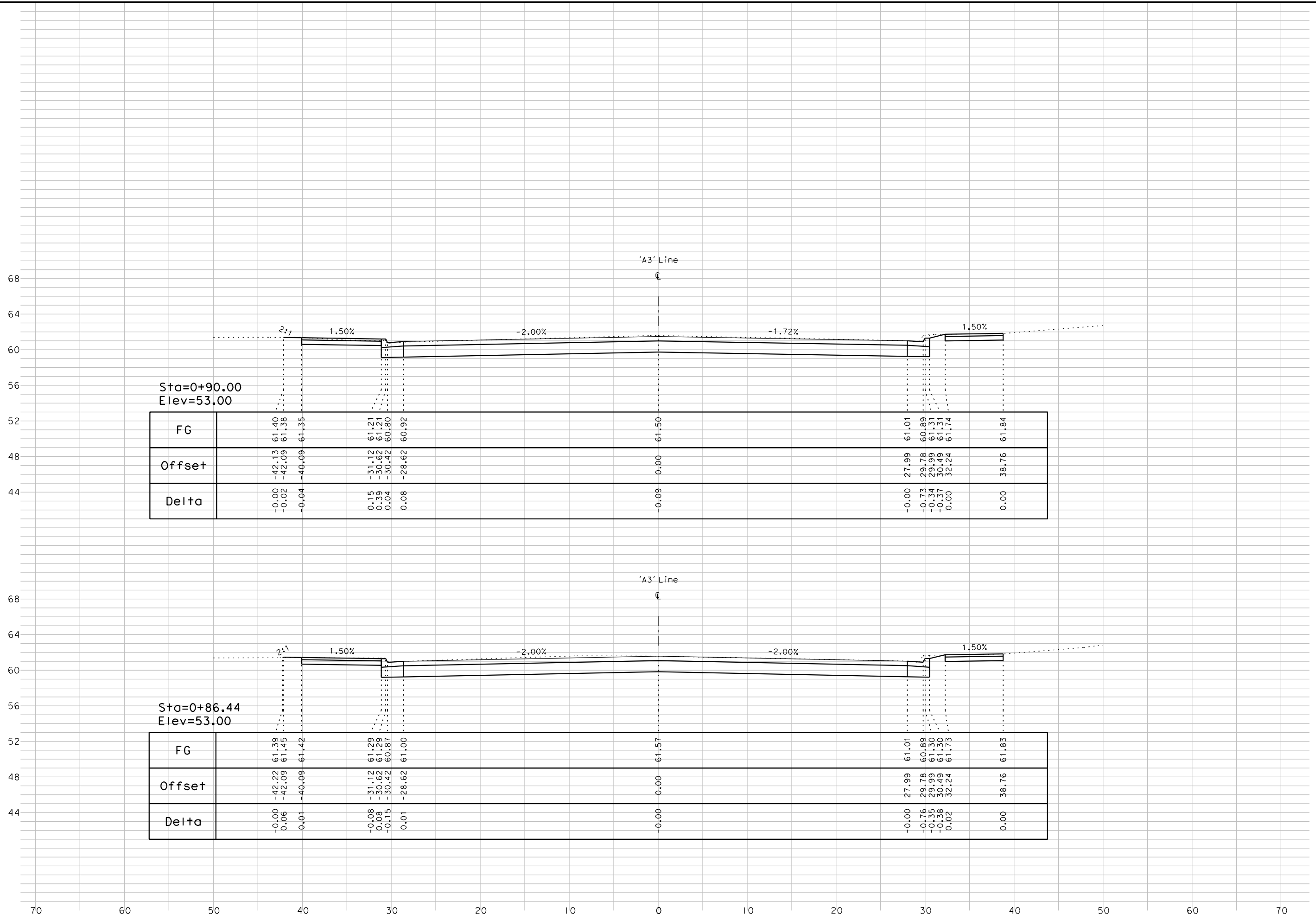

042617.A11

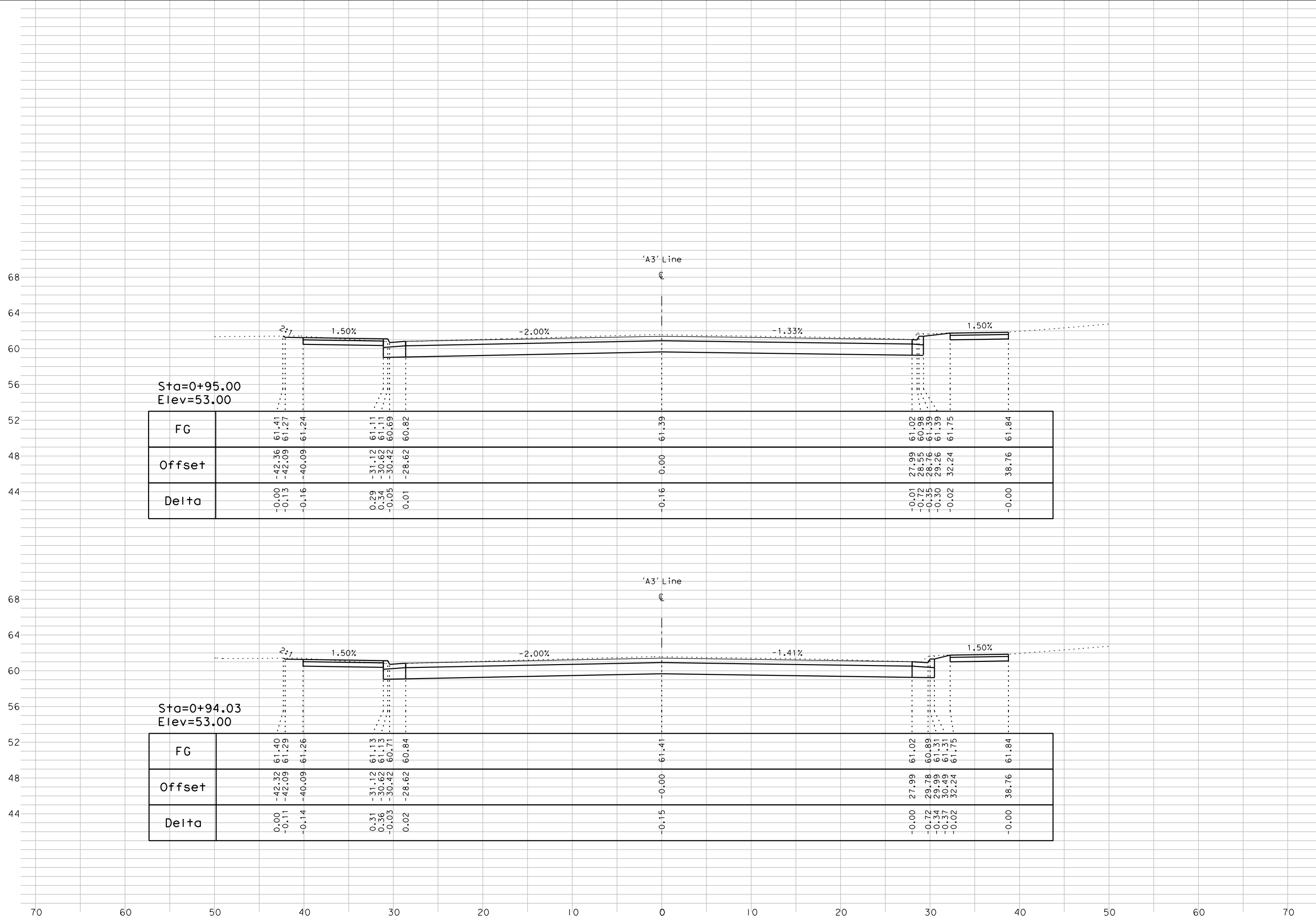

Sta=0+95.00
Elev=53.00

FG	-0.00	-0.13	-0.16		0.29	0.34	-0.05	0.01	-0.16	0.00	61.39		-0.01	-0.72	-0.55	-0.30	-0.02	-0.00	
Offset	-42.36	-42.09	-40.09		-31.12	-30.62	-30.42	-28.62	0.00	27.99	28.155	28.76	29.126	32.24	38.76				
Delta	61.41	61.27	61.24		61.11	61.11	60.69	60.82	61.39	61.02	60.98	61.39	61.75	61.84					

Sta=0+94.03
Elev=53.00

FG	0.00	-0.11	-0.14		0.31	0.36	-0.03	0.02	-0.15	-0.00	61.41		-0.00	-0.72	-0.54	-0.37	-0.02	-0.00	
Offset	-42.32	-42.09	-40.09		-31.12	-30.62	-30.42	-28.62	0.00	27.99	29.78	29.99	30.49	32.24	38.76				
Delta	61.40	61.29	61.26		61.13	61.13	60.71	60.84	61.41	61.02	60.89	61.31	61.75	61.84					

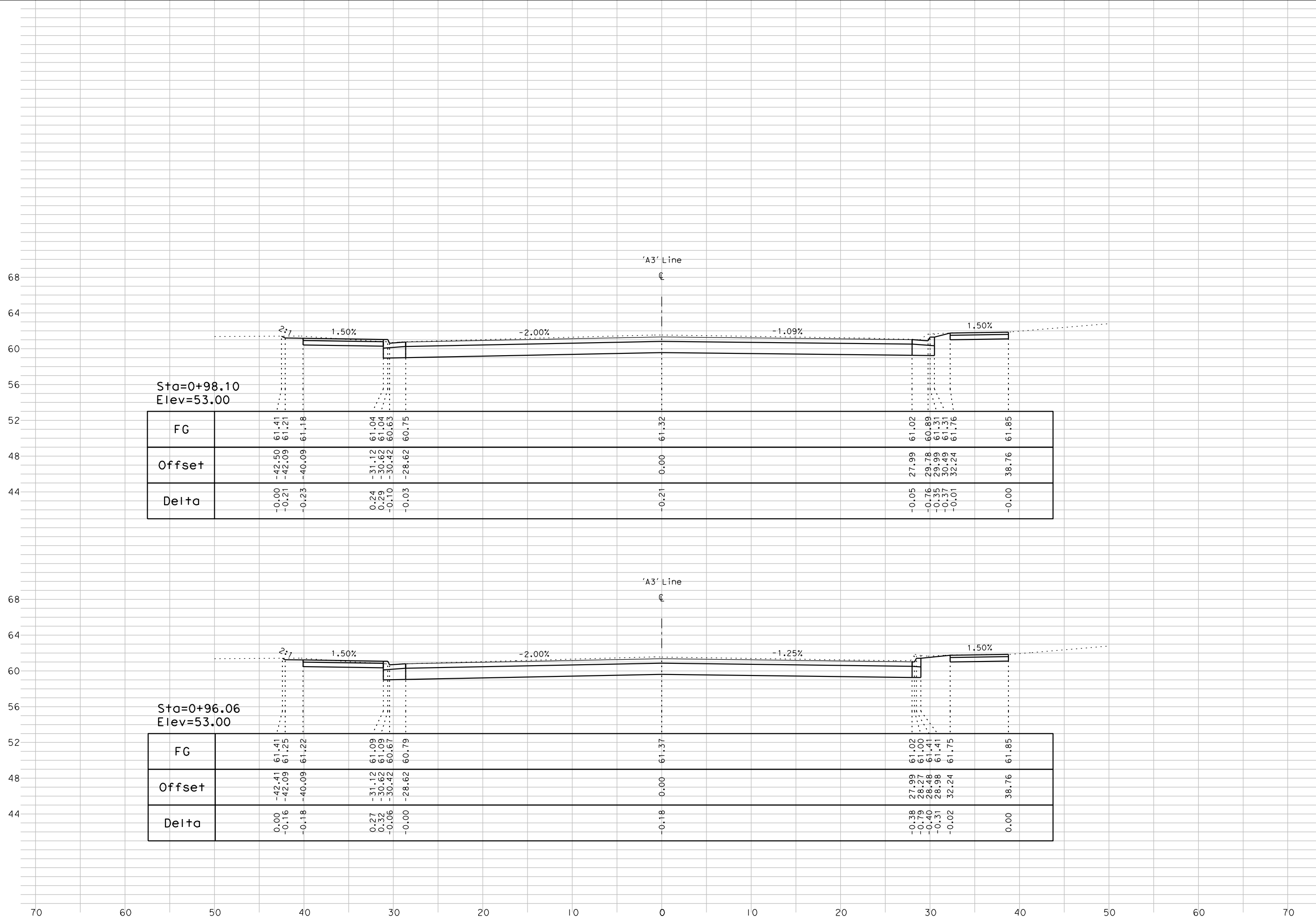

Sta=0+98.10
Elev=53.00

FG		61.41	61.21		61.04	61.04	60.63	60.75	61.32	61.02	60.89	61.31	61.76	61.85
Offset		-42.50	-42.09	-40.09	-31.12	-30.62	-30.42	-28.62	0.00	27.99	29.78	29.99	30.49	38.76
Delta		-0.00	-0.21	-0.23	0.24	0.29	-0.10	-0.03	-0.21	-0.05	-0.76	-0.35	-0.37	-0.00

Sta=0+96.06
Elev=53.00

FG		61.41	61.25	61.22	61.09	61.09	60.67	60.79	61.37	61.02	61.00	61.41	61.75	61.85
Offset		-42.41	-42.09	-40.09	-31.12	-30.62	-30.42	-28.62	0.00	27.99	28.27	28.48	28.98	38.76
Delta		0.00	-0.16	-0.18	0.27	0.32	-0.06	-0.00	-0.18	-0.38	-0.79	-0.40	-0.31	0.00

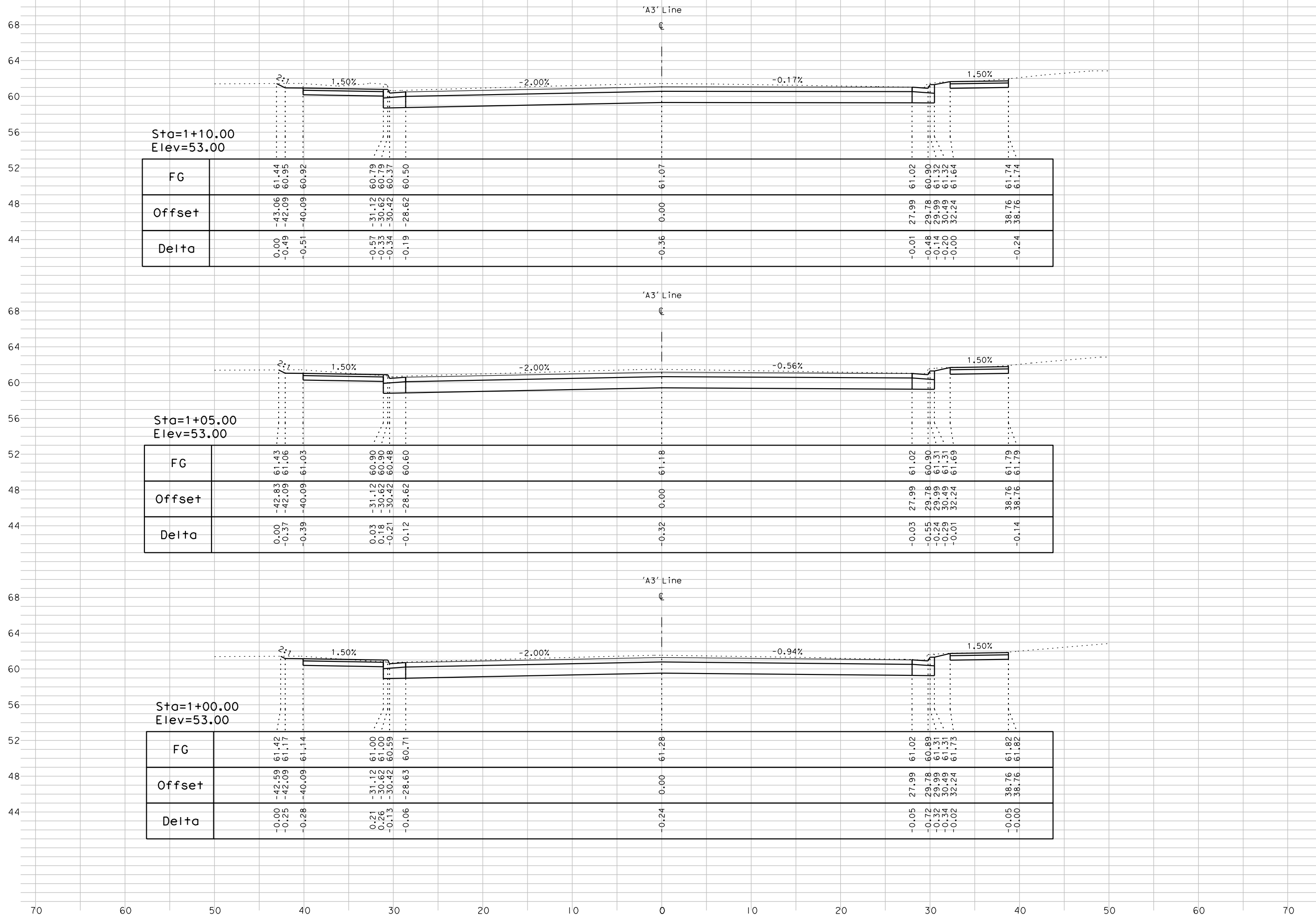

Sta=1+10.00
Elev=53.00

FG	61.44	61.44	60.92	60.79	60.79	60.50	61.02	61.02	61.74	61.74
Offset	-43.06	-42.09	-40.09	-31.12	-30.62	-28.62	0.00	27.99	29.78	38.76
Delta	0.00	-0.49	-0.51	-0.57	-0.33	-0.19	-0.36	-0.01	-0.48	-0.24

Sta=1+05.00
Elev=53.00

FG	61.43	61.06	61.03	60.90	60.90	60.60	61.18	61.02	61.79	61.79
Offset	-42.83	-42.09	-40.09	-31.12	-30.62	-28.62	0.00	27.99	29.78	38.76
Delta	0.00	-0.37	-0.39	0.03	0.18	-0.12	-0.32	-0.03	-0.55	-0.14

Sta=1+00.00
Elev=53.00

FG	61.42	61.17	61.14	61.00	61.00	60.71	61.28	61.02	61.82	61.82
Offset	-42.59	-42.09	-40.09	-31.12	-30.62	-28.63	0.00	27.99	29.78	38.76
Delta	-0.00	-0.25	-0.28	0.21	0.26	-0.06	-0.24	-0.05	-0.32	-0.05

042617_A.II

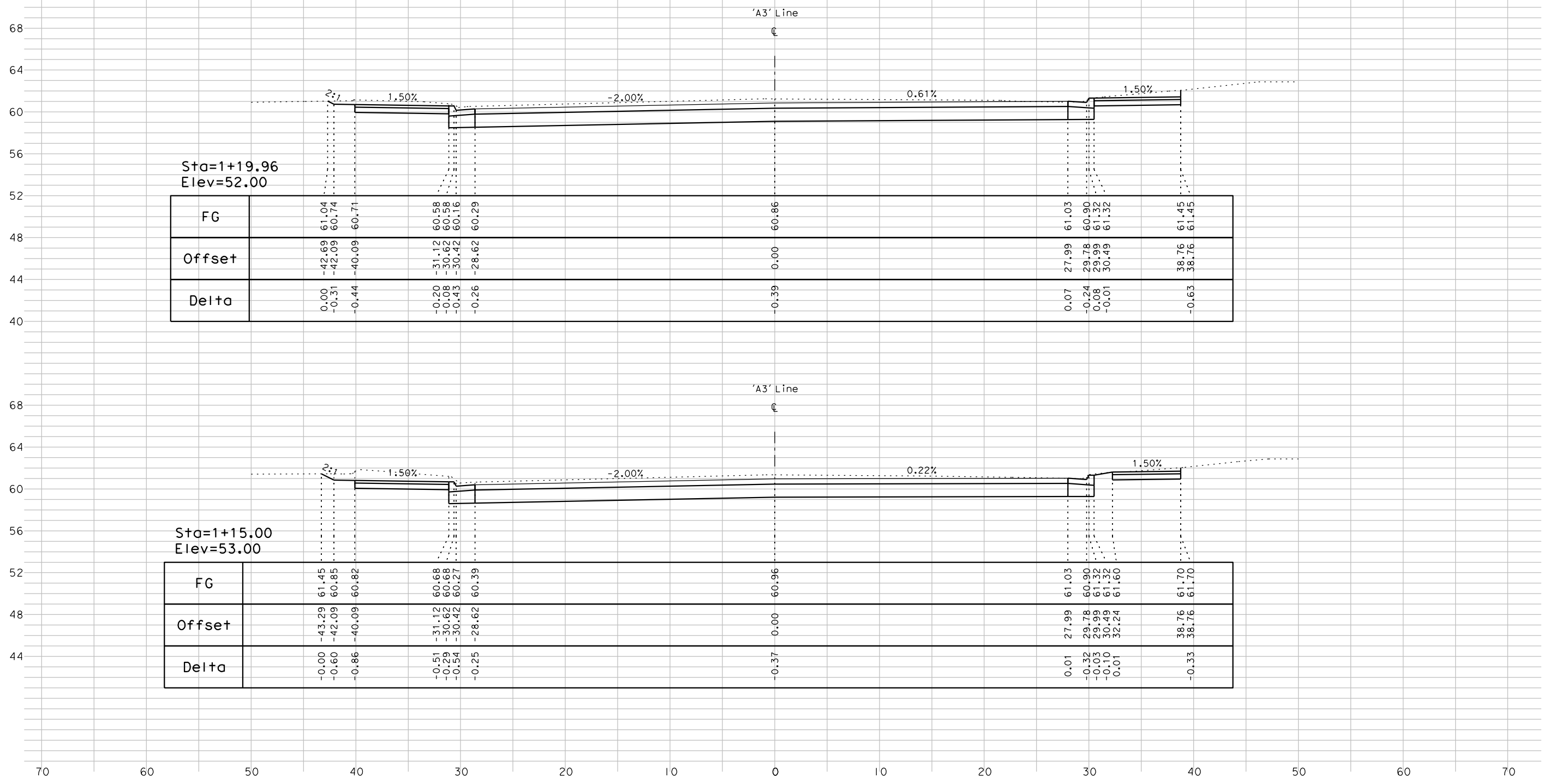

Sta=1+19.96
Elev=52.00

FG		61.04	60.74	60.71		60.58	60.58	60.16	60.29	60.96	61.03	60.90	61.32	61.32	61.45	61.45
Offset		-42.69	-42.09	-40.09		-31.12	-30.62	-30.42	-28.62	0.00	27.99	29.78	29.99	30.49	38.76	38.76
Delta		0.00	-0.31	-0.44		-0.20	-0.08	-0.43	-0.26	-0.39	0.07	-0.24	0.08	-0.01	-0.63	-0.63

Sta=1+15.00
Elev=53.00

FG		61.45	60.85	60.82		60.88	60.88	60.27	60.39	60.96	61.03	60.90	61.32	61.32	61.70	61.70
Offset		-43.29	-42.09	-40.09		-31.12	-30.62	-30.42	-28.62	0.00	27.99	29.78	29.99	30.49	38.76	38.76
Delta		-0.00	-0.60	-0.86		-0.51	-0.29	-0.54	-0.25	-0.37	0.01	-0.32	-0.03	-0.10	-0.33	-0.33

042617_A.II

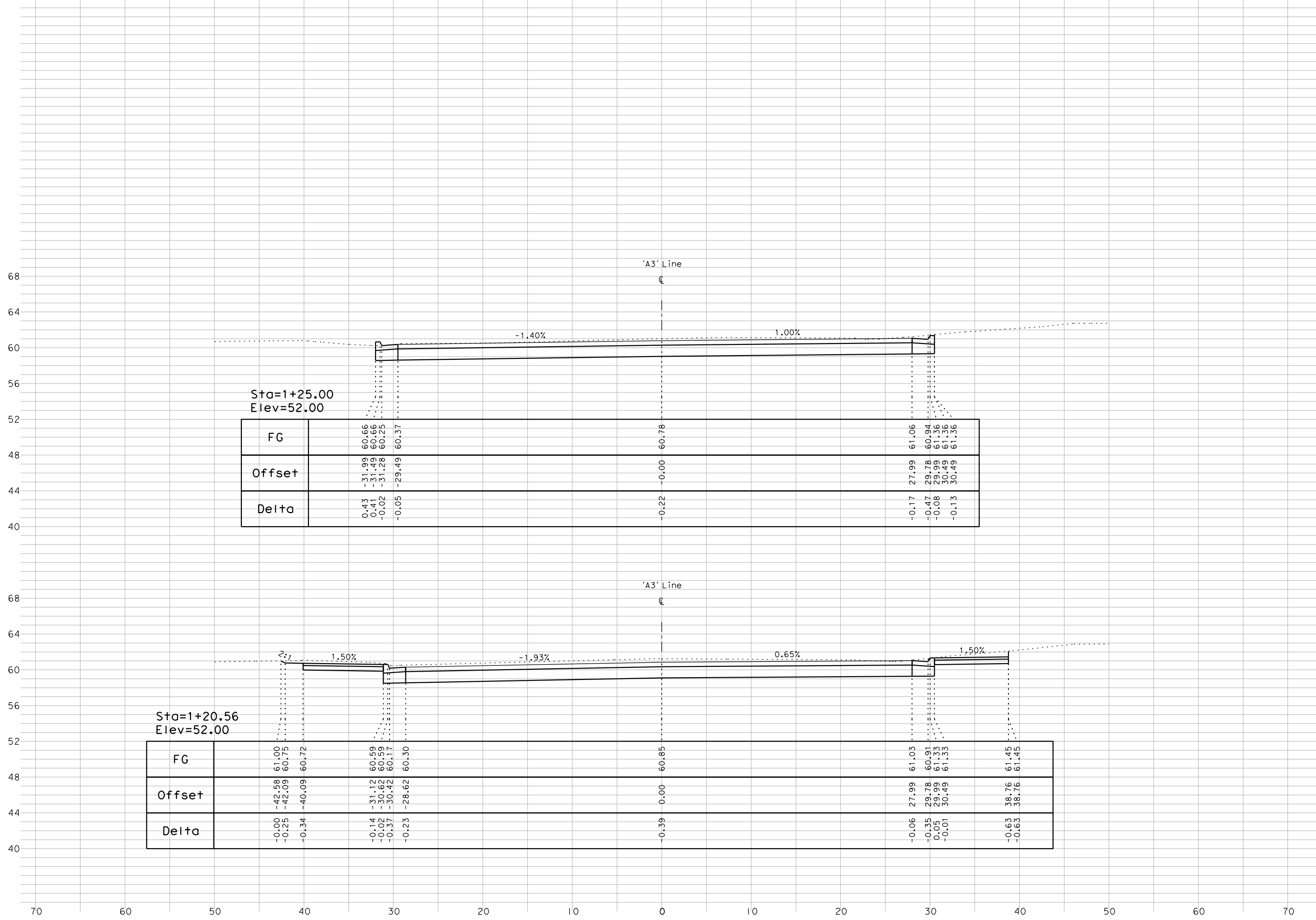

Sta=1+25.00
Elev=52.00

FG		60.66	60.66	60.78	61.06
Offset		-31.99	-31.49	-0.00	27.99
Delta		0.43	0.41	-0.22	-0.17

Sta=1+20.56
Elev=52.00

FG		61.00	60.75	60.59	60.85	61.03	61.45
Offset		-42.58	-42.09	-31.12	-0.00	27.99	38.76
Delta		-0.00	-0.25	-0.14	-0.39	-0.06	-0.63

042617_A.II

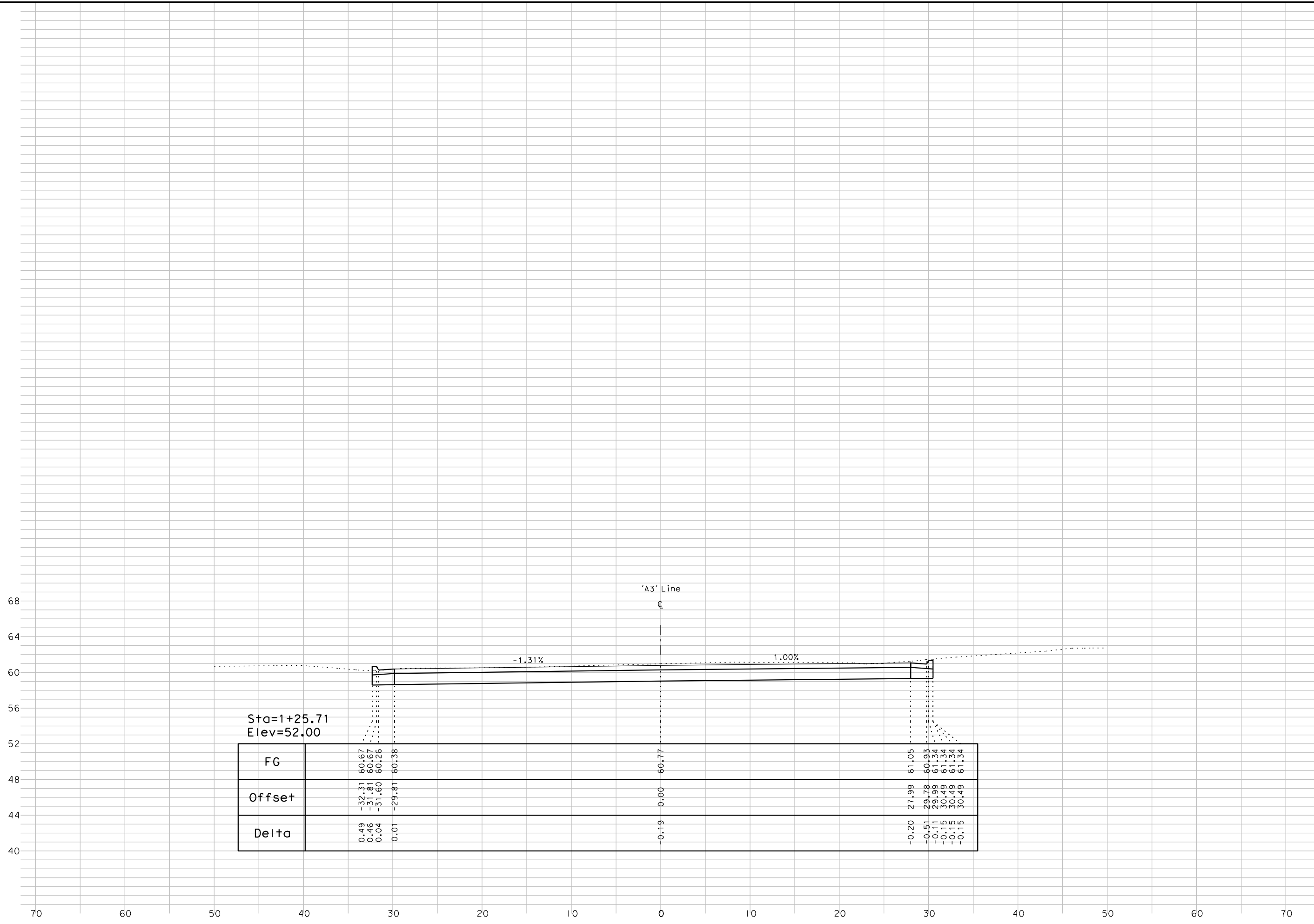

Sta=1+25.71
Elev=52.00

'A3' Line

-1.31%

1.00%

DATE:	04/5/17	BY:	A.JL
JOB NO.:	1858	SCALE:	1"=5' Horiz 1"=5' Vert

PROJECT: 5th St. Bridge Replacement Project
City of Yuba City

CROSS SECTIONS
File Name: 1858_A3_XS_Sheet.dgn

'A3' Line - "Sutter St. Alley"

7
7